

5-4-15 BLOWER HOUSING AND RECOIL STARTER

- (1) Attach blower housing to crankcase. Tighten five flange bolts.

M6 x 12 mm flange bolt : 5 pcs.

Insert the high tension cord from the ignition coil into the notch of the blower housing so that not to pinch the cord.

- (2) Install recoil starter to blower housing.

M6 x 8 mm flange bolt : 4 pcs.

Note:

Be careful of pulling direction of starter rope.

5-4-16 GOVERNOR, SPEED CONTROL SYSTEM AND CARBURETOR

- (1) Install governor lever to governor shaft.
Tighten locking bolt temporarily.
- (2) Install speed control lever to cylinder baffle, friction washer, self lock nut, etc. as shown in illustration.
- (3) Hook governor spring to proper holes of governor lever and speed control lever.
(See Fig. 5-42 and below.)

Discrimination of governor spring :

Parts No.	Color	Application	Frequency	Hooking position
267-42501-03	Silver	STD	60Hz	4 - C
			50Hz	5 - C
267-42502-01	Gold	Generator	60Hz	2 - C
			50Hz	4 - C

- (4) Install insulator and gaskets for carburetor to cylinder head.

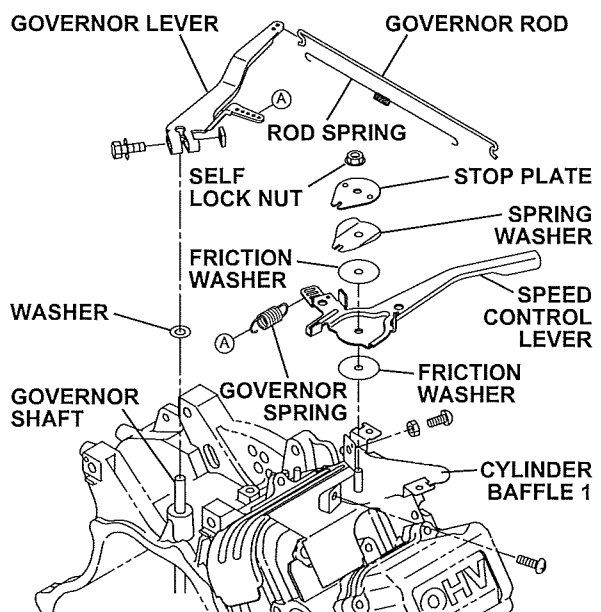

Fig. 5-41

- (5) Install carburetor to cylinder head hooking governor rod to governor lever and throttle lever of carburetor. Hook rod spring over governor rod.
- (6) Attach air cleaner base to carburetor. Tighten two flange nuts and a bolt.

**Tightening torque : 6.9 - 8.8 N·m
(70 - 90 kgf·cm)
(5.1 - 6.5 ft·lb.)**

Connect breather pipe from rocker cover to cleaner base.

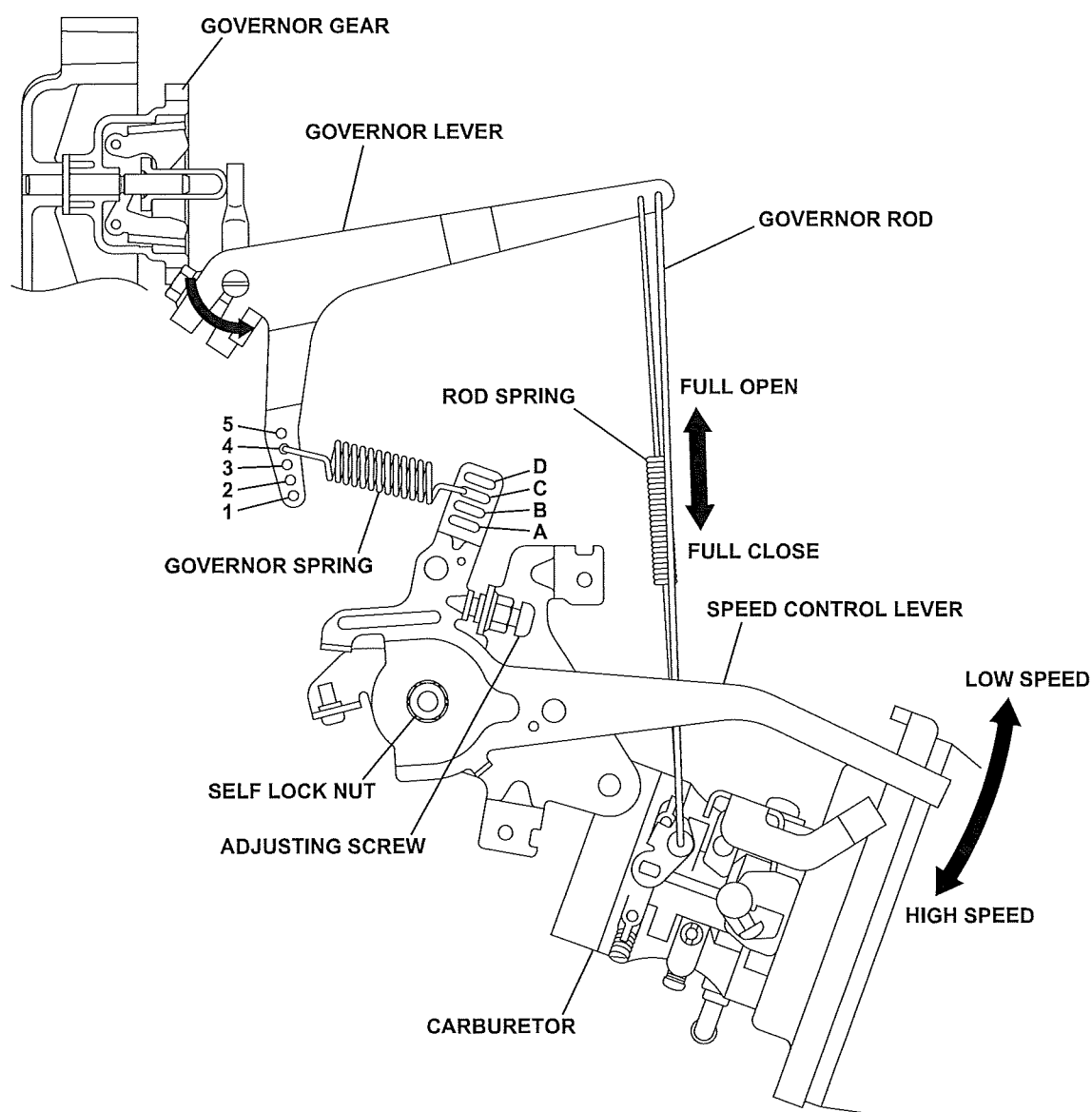

Fig. 5-42

(7) Adjust governor system.

- (a) Turn the speed control lever all the way toward the high speed position and fix it by tightening self lock nut.
- (b) Check that governor lever is pulled by governor spring and carburetor throttle valve is fully open.
- (c) Turn governor shaft counterclockwise all the way using a screw driver, and tighten lock bolt to secure the lever on the shaft.
- (d) Loosen the self lock nut to allow the speed control lever to move freely.

Tightening torque : 8.8 - 10.8 N·m (90 - 110 kgf·cm) (6.5 - 8.0 ft·lb.)
--

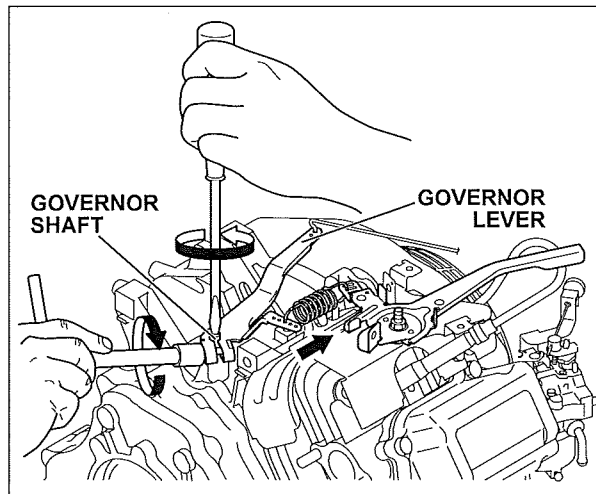

Fig. 5-43

5-4-17 MUFFLER

- (1) Install muffler bracket to cylinder head.
M8 x 16 mm bolt : 2 pcs.
- (2) Install muffler to muffler bracket.
M8 flange nut : 2 pcs.
- (3) Install muffler cover.
M6 tapping screw : 5 pcs.

Muffler and Muffler bracket (M8 bolt & nut)

Tightening torque : 22.6 - 26.5 N·m (230 - 270 kgf·cm) (16.6 - 19.5 ft·lb.)
--

5-4-18 STOP SWITCH

- (1) Install stop switch to blower housing.
- (2) Connect wires referring to the wiring diagram.

5-4-19 ELECTRIC STARTER AND CONTROL BOX CP (Optional equipment)

- (1) Install electric starter to crankcase.
- (2) Install control box cp (include magnetic switch, diode rectifier and key switch) to crankcase.
- (3) Connect wires referring to the wiring diagram.

5-4-20 FUEL TANK

- (1) Install fuel tank to crankcase.
M8 x 20 mm bolt : 4 pcs.
- (2) Connect fuel strainer and fuel inlet of carburetor with the fuel hose. Be sure to clamp securely.

5-4-21 AIR CLEANER

Install air cleaner element and cleaner cover.

— End of the reassembly —